



3M™ 600 Series Headtops HT-639



Care and Maintenance

To maintain protection levels, optimise the effective lifetime of the system and avoid the additional cost of replacement, it is extremely important to carry out regular checks and maintenance on Powered and Supplied Air Respirators.

Before Use

- Inspect Comfort Band – remove and replace if necessary
- Inspect Face Seal – ensure it is free from splits or holes
- Ensure shield angle and head harness size are correctly set
- Ensure Pivot Nuts are secure
- Ensure Welding Filter and Cover Lenses are correctly fitted and undamaged
- Ensure correct shade setting is selected
- Inspect Head Harness and Air Duct
- Ensure all parts are free from cracks and splits - replace if necessary

Monthly

- Carry out all the ‘Before Use’ inspections and create record of this monthly check

After Use

- Clean with cloth dampened with a mild solution of water and liquid household soap
- Disinfect with 3M™ 105 Wipes
- Store in a dry, clean area / locker away from direct sunlight, high temperatures and solvents

Ordering Consumables, Repair Parts and Accessories

To request a quote or place an order for these items, please contact your 3M Approved Distributor.

Further Information and Advice

If you require additional guidance on the Care and Maintenance of your 3M Powered and Supplied Air Equipment, please contact the Helpline or your local 3M representative.

3M Health & Safety Helpline
Monday - Friday 9 to 5
0870 60 800 60 UK
1 800 320 500 IRELAND

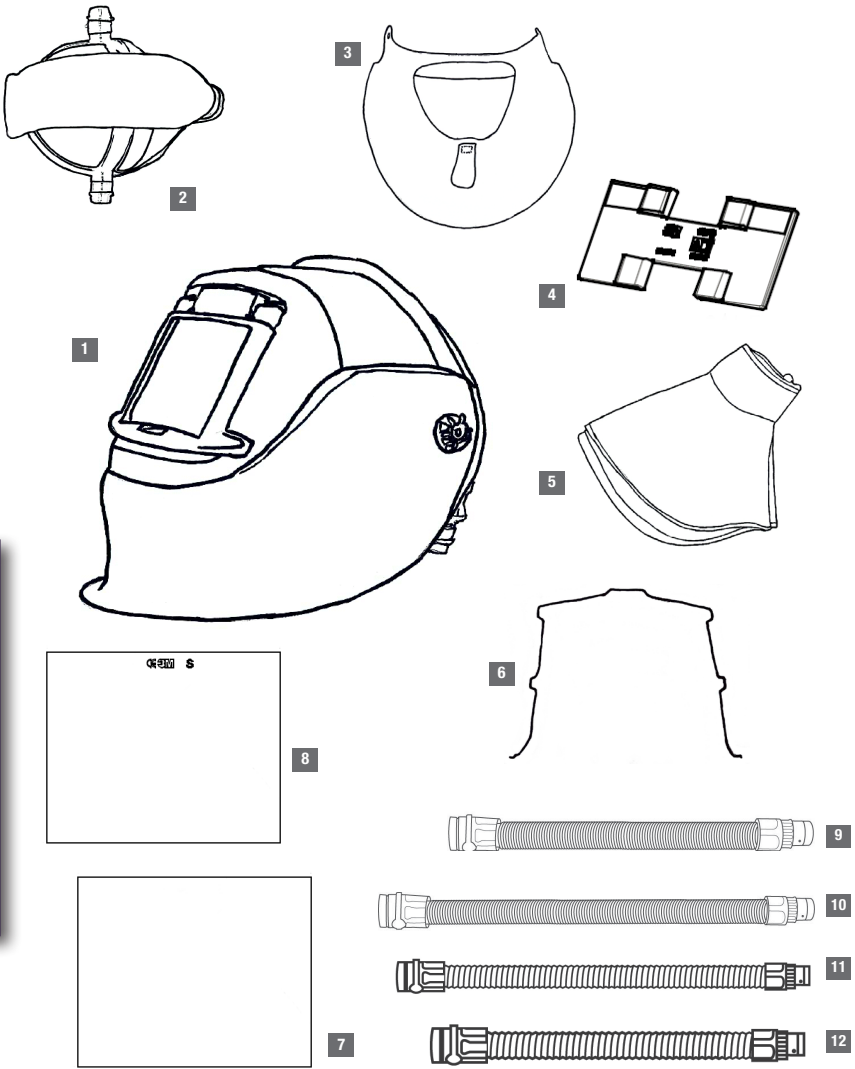

		3M Part No
1	HT-639 Welding Visor Headtop	HT-639
2	600 Series Airduct Harness Assembly	HNS-14
3	Faceseal	FSL-23
4	Comfort Bands 600 Series (pair)	CMF-09
5	Proban™ Welding Cape	WLD-12
6	Lens Retainer Spring	WLD-13
7	Inner Cover Lens (90 x 110mm)	WLN-20
8	90 x 110mm Outer Cover Lens	WLN-13
	Speedglas 100V Auto Darkening Filter Variable 3/8-12	750020
9	Breathing Tube, small/medium	BT-20S
10	Breathing Tube, medium/large	BT-20L
11	Length Adjusting Breathing Tube	BT-30
12	Heavy Duty Rubber Breathing Tube	BT-40
	Protective cover for breathing tubes	BT-926

A well-balanced shield giving superb coverage, with a 90 x 110mm filter holder, able to hold a conventional glass or auto-darkening filters.

@3M_UK_Safety

3M Personal Safety Division
3M United Kingdom plc
3M Centre
Cain Road, Bracknell
Berkshire RG12 8HT
Tel: 0870 60 800 60
www.3M.co.uk/safety

3M Ireland Limited
The Iveagh Building
The Park
Carrickmines
Dublin 18
Tel: 1 800 320 500

17808
3M is a trademark of 3M Company
Please recycle. Printed in UK.
© 3M 2014. All rights reserved.

REPLACE ALL DAMAGED PARTS IMMEDIATELY TO ENSURE
CORRECT LEVELS OF PROTECTION



CHHT639CMP

To download this poster please visit:
www.3M.co.uk/maintenancepack or scan the QR code

