



Alkalinity-m T

M30

5 - 200 mg/l CaCO₃

tA

Acid / Indicator

Instrument specific information

The test can be performed on the following devices. In addition, the required cuvette and the absorption range of the photometer are indicated.

Instrument Type	Cuvette	λ	Measuring Range
MD 100, MD 110, MD 200, MD 600, MD 610, MD 640, MultiDirect, PM 600, PM 620, PM 630	ø 24 mm	610 nm	5 - 200 mg/l CaCO ₃
Scuba II	ø 24 mm		0 - 300 mg/l CaCO ₃
SpectroDirect, XD 7000, XD 7500	ø 24 mm	615 nm	5 - 200 mg/l CaCO ₃

Application List

- Drinking Water Treatment
- Waste Water Treatment
- Raw Water Treatment
- Pool Water Treatment
- Pool Water Control

Notes

1. The terms Alkalinity-m, m-Value, total alkalinity and Acid demand to $K_{s4.3}$ are identical.
2. For accurate results, exactly 10 ml of water sample must be used for the test.



Implementation of the provision Alkalinity, total = Alkalinity-m = m-Value with Tablet

Select the method on the device

For this method, no ZERO measurements are to be carried out with the following devices: XD 7000, XD 7500



Fill 24 mm vial with **10 ml sample**.

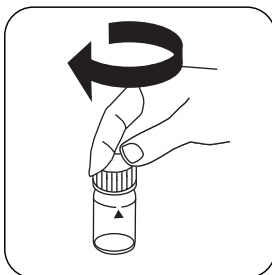

Close vial(s).

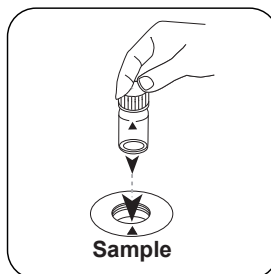

Place **sample vial** in the sample chamber. • Pay attention to the positioning.

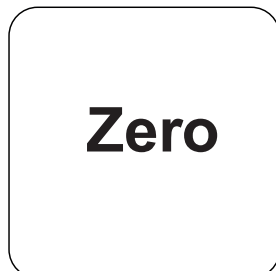

Press the **ZERO** button.

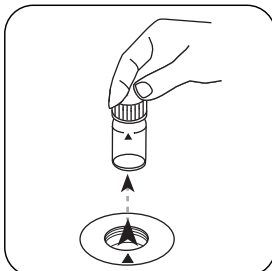

Remove the vial from the sample chamber.

For devices that require **no ZERO measurement**, start here.

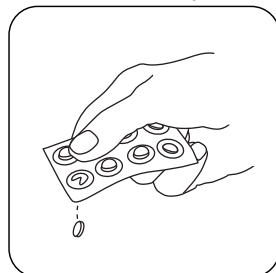

Add **ALKA-M-PHOTOMETER** tablet.

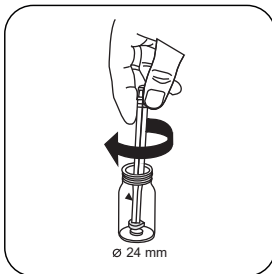

Crush tablet(s) by rotating slightly.

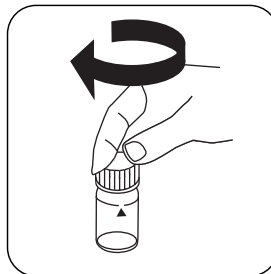

Close vial(s).

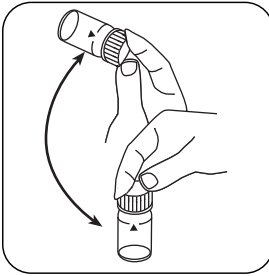

Dissolve tablet(s) by inverting.

The result in Alkalinity-m appears on the display.

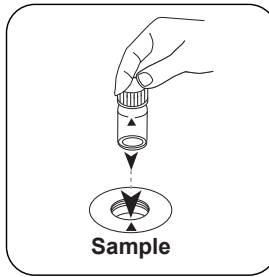

Place **sample vial** in the sample chamber. • Pay attention to the positioning.

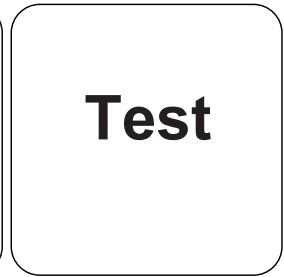

Press the **TEST** (XD: **START**) button.



Analyses

The following table identifies the output values can be converted into other citation forms.

Unit	Cite form	Scale Factor
mg/l	CaCO ₃	1
	°dH	0.056
	°eH	0.07
	°fH	0.1
	°aH	0.058
	K _{S4.3}	

Chemical Method

Acid / Indicator

Appendix

Calibration function for 3rd-party photometers

Conc. = $a + b \cdot \text{Abs} + c \cdot \text{Abs}^2 + d \cdot \text{Abs}^3 + e \cdot \text{Abs}^4 + f \cdot \text{Abs}^5$

Note

Please select items for "Fields".

Derived from

EN ISO 9963-1

Distributed By: Camlab Ltd
 Unit 24, Norman Way Industrial Estate
 Over, Cambridge, CB24 5WE, United Kingdom
 T: +44 (0) 1954 233 110 E: sales@camlab.co.uk

