

PORKKA



Medi Line MC, M1, M2, M3, VL

TECHNICAL DATA

2012 01

Technical data MC 70, MC 180, MC 150/150, MC 300

				MC 70	MC 180	MC 150/150	MC 300
Ext. dimension	width	(mm)		595	595	595	595
	depth	(mm)	(+handle)	480+25	480+25	480+25	480+25
	height	(mm)	(wall installation*)	720	-	-	-
	height	(mm)	(free-standing)	900	1300	2000	2000
	height	(mm)	(free-standing, low)	800			
Int. dimension	width	(mm)		495	495	495	495
	depth	(mm)		360	360	360	360
	height	(mm)		495	940	780+780	780+780
Volume net		(l)		75	130	110+110	110+110
Volume gross		(l)		95	170	143+143	110+110
Weight		(kg)		55	70	150	120
Shelves	width	(mm)		490	490	490	490
	depth	(mm)		155	155	155	155
Door shelves	width	(mm)			470	470	470
	depth	(mm)			100	100	100
Amb. Temperature		(°C)		+5...+32	+5...+32	+5...+32	+5...+32
Operating temperature		(°C)		+2...+15	+2...+15	+2...+15	+2...+15
Connection power		(W)		150	190	380 (190+190)	190
Cooling effect		(W)		108	137	137+137	137
evaporator/condensor/ambient				-10°C/+55°C/+32°C	-10°C/+55°C/+32°C	-10°C/+55°C/+32°C	-10°C/+55°C/+32°C
Refrigerant				R 134A / 80g	R 134A / 100g	R 134a / 100+100g	R 134A / 100g
Fuse (slow)		(A)		10	10	10	10
Voltage		(V)		230/50 Hz	230/50 Hz	230/50 Hz	230/50 Hz
Defrost				3	3	3	3
1. Air							
2. Hotgas							
3. Electric							

Exterior finish	Visible exterior surface: white polyester-coated sheet steel; back wall, top and bottom galvanised sheet steel
Interior finish	Vacuum formed polystyrene
Insulation (body)	40 mm foamed, CFC and HCFC free polyurethane
Door	Equipped with magnetic gasket and lock, reversible
Feet	MC180, MC150/150 and MC300 4 psc adjustable 20 mm fingerscrews, MC70 with steel base frame
Inside	Plastic shelves
Refrigeration system	Hermetic, air conditioned, with heat exchanger and capillary
Evaporator	Static evaporator with automatic defrosting
Standard equipment	Electronic controlled digital thermometer/thermostat/defrost timer with alarm light, (adjustable low and high temperature alarm limits) and an option to external alarm (potential free relais contact),TTL -Mod Bus (RS 485) port for the option to connect to PC, readiness for additional probes
	Alternatives and accessories, see the price list
Note !	All data and volumes are given according to ISO 8561

Dimension drawings MC 70, MC 180, MC 150/150, MC 300

MC 70

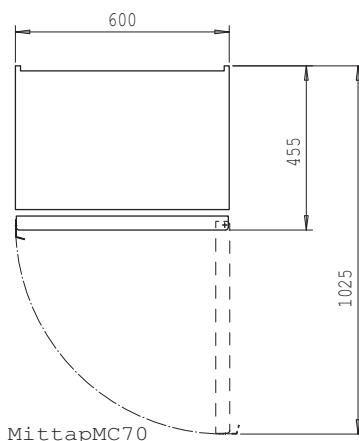
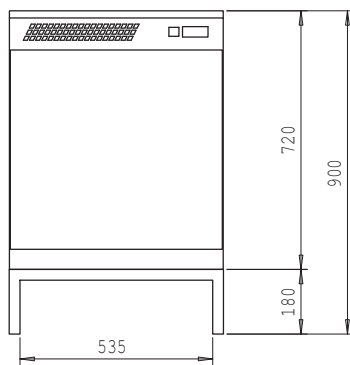

MittapMC70

MC 180

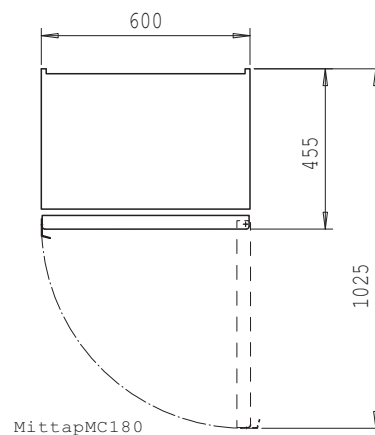
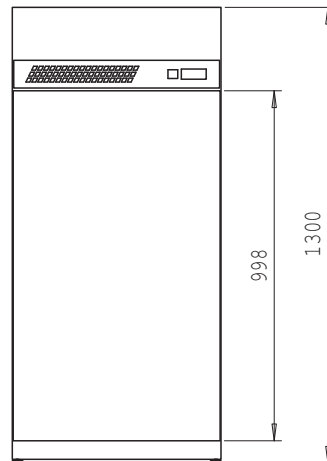

MittapMC180

MC 300
MC 150/150

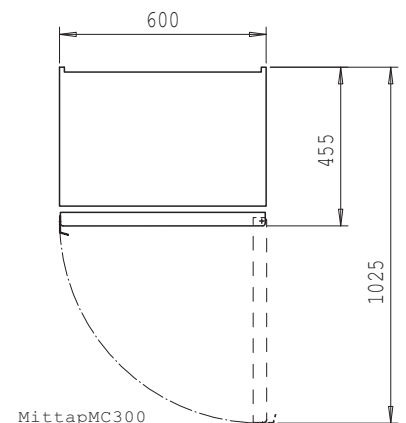
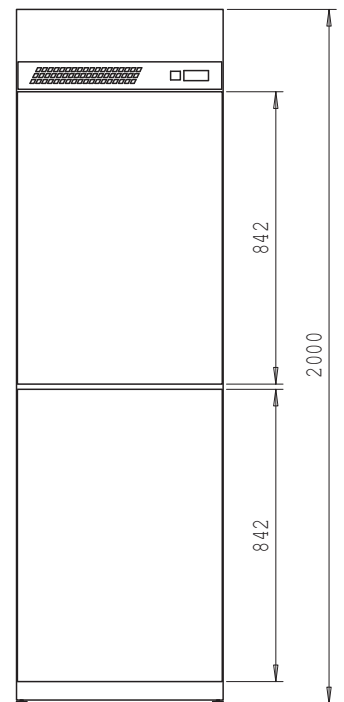

MittapMC300

MC 150/150



MC 300



MC 180



MC 70



Wall installation MC 70*

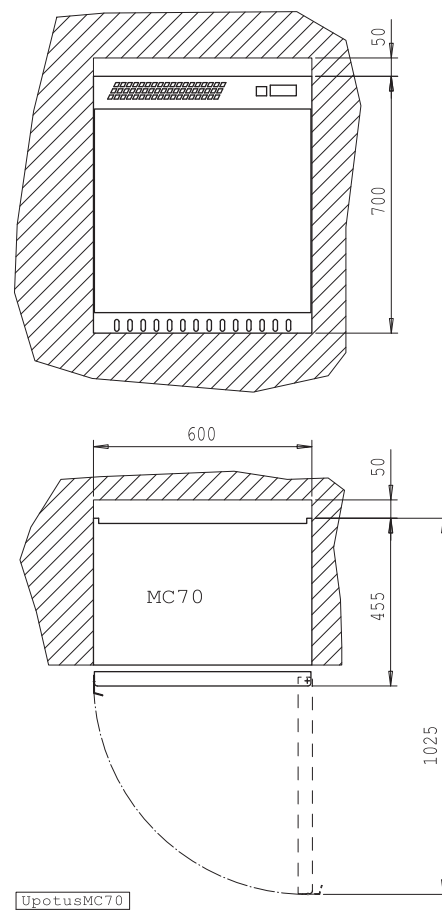
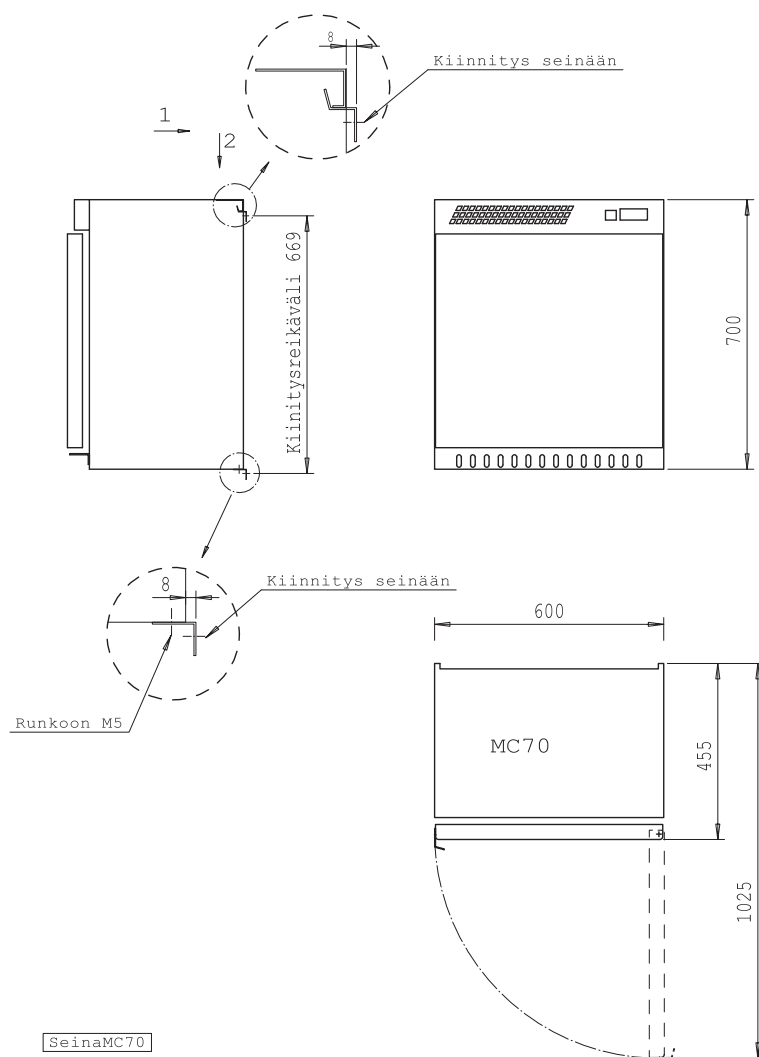

Technical data M1, M2 - AK, M2 - VL

				M1	M2 - AK	M2 - VL
Ext. dimension	width	(mm)		596	596	596
	depth	(mm)	(+handle)	425+25	425+25	425
	height	(mm)	(wall installation**)	1100	-	-
	height	(mm)	(free-standing)	-	2000	2000
Int. dimension	width	(mm)		500	500	500
	depth	(mm)		380	380	380
	height	(mm)		1040	1040+680	680
Volume net		(l)		199	199+135	199+135
Volume gross		(l)		220	220+145	220+145
Weight		(kg)		45	90	95
Shelves	width	(mm)		490	490	490
	depth	(mm)		155	155	155
Drawers	width	(mm)				508 / 508
	depth	(mm)				376 / 376
	height	(mm)				148 (x 3) VL 3
	height	(mm)				74 (x 6) VL 6
Door shelves	width	(mm)		470	470	470
	depth	(mm)		100	100	100
Connection power		(W)		25	25	25
Fuse (slow)		(A)		10	10	10
Voltage		(V)		230/50 Hz	230/50 Hz	230/50 Hz

Frame	White melamine coated panel
Door and drawer	White laminated door and drawers are lockable, reversible door
Feet	Steel base frame, 4 pcs of adjustable 20 mm knurled-head screws
Shelves	Plastic shelves dimensioned for medicines
	Door with lockers with dividers dimensioned for medicines
Standard Equipment	M1: interior light with door switch, lockable drawer for drugs with different key series than the door
	M1 can be united with MC 70 medical refrigerator
	M1 bottom cabinet with pull-out dosing plane for medicines
	M2: interior light with door switch, lockable drawer for drugs with different key series as for the door
	M2 lower compartment can be a drawer VL with central locking with 3 or 6 drawers or under-cupboard AK
	Alternatives and accessories, see the price list
Note!	Volumes are given according to EN441 standard

Dimension drawings M1, M2 - AK, M2 - VL

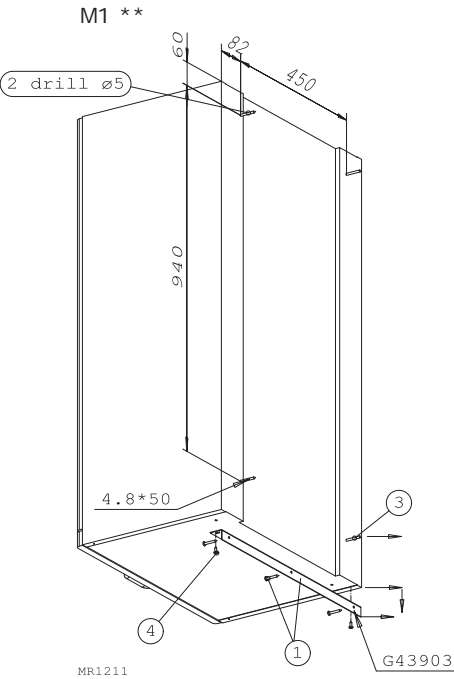
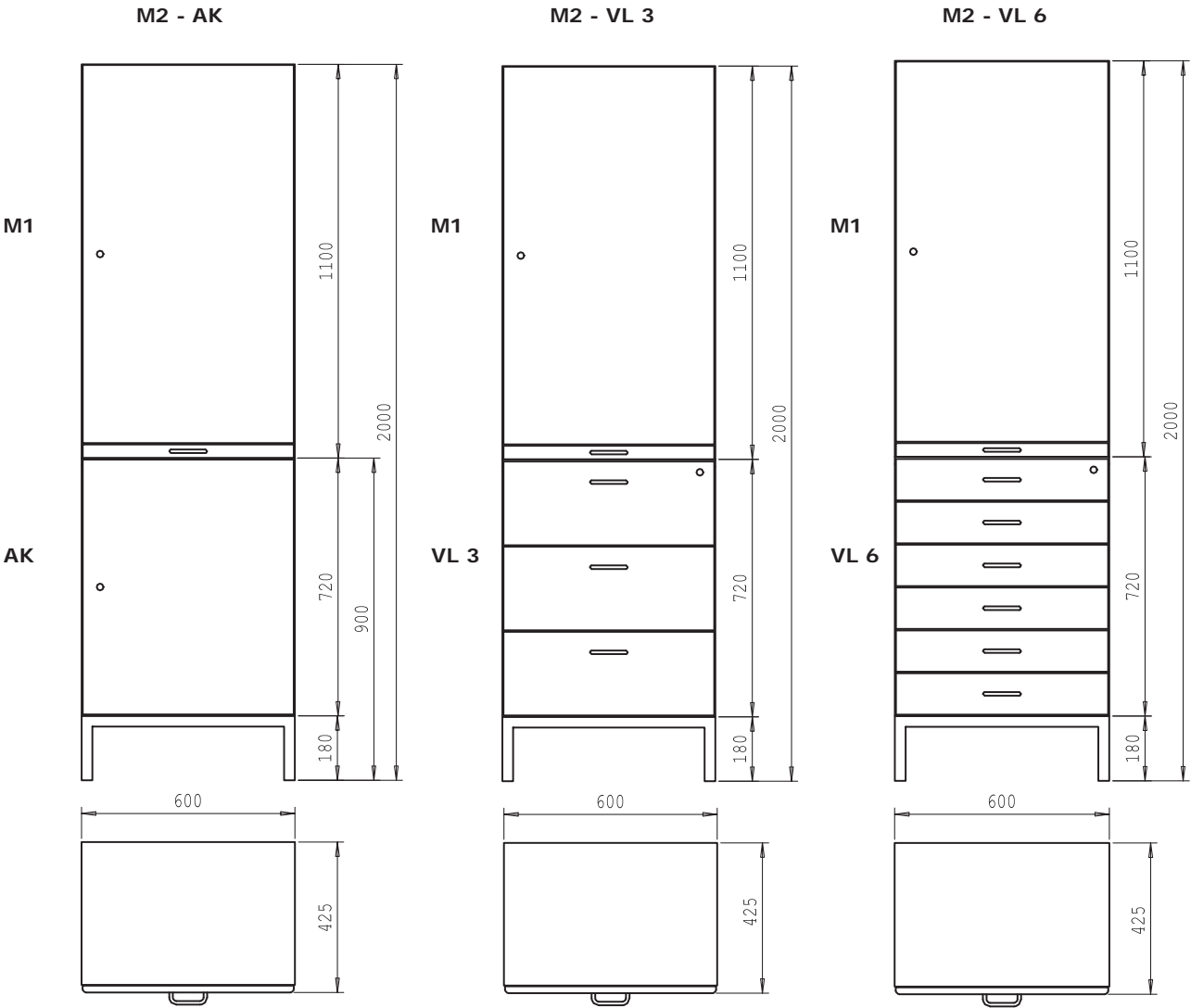

Technical data M1 + MC 70, MC 70 + VL

				M1 + MC 70	MC 70 + VL
Ext. dimension	width	(mm)		596	596
	depth	(mm)	(+handle)	480+25	480+25
	height	(mm)	(wall installation)	-	-
	height	(mm)	(free-standing)	2000	1620
Int. dimension	width	(mm)		500/495	495/500
	depth	(mm)		380/360	360/380
	height	(mm)		1040/495	495/680
Volume net		(l)		199+75	75+135
Volume gross		(l)		220+95	95+145
Weight		(kg)		100	105
Shelves	width	(mm)		490	490
	depth	(mm)		155	155
Drawers	width	(mm)			525 / 525
	depth	(mm)			380 / 380
	height	(mm)			148 (x 3) VL 3
	height	(mm)			74 (x 6) VL 6
Door shelves	width	(mm)		470	
	depth	(mm)		100	
Amb. Temperature		(°C)		+5...+32	+5...+32
Operating temperature		(°C)		+2...+15	+2...+15
Connection power		(W)		150+25	150
Cooling effect		(W)		108	108
evaporator/condensor/ambient				-10°C/+55°C/+32°C	-10°C/+55°C/+32°C
Refrigerant				R 134A / 80g	R 134A / 80g
Fuse (slow)		(A)		10	10
Voltage		(V)		230/50 Hz	230/50 Hz
Defrost				3	3
1. Air					
2. Hotgas					
3. Electric					

Technical data M1 + MC 70, MC 70 + VL

MC70	
Exterior Finish	Visible exterior surface: white polyester-coated sheet steel; back wall, top and bottom galvanised sheet steel
Inside	Vacuum formed polystyrene
Insulation (body)	40 mm foamed, CFC and HCFC free polyurethane
Door	Equipped with magnetic gasket and lock, reversible
Feet	Steel base frame, 4 pcs of adjustable 20 mm knurled-head screws
Shelves	Plastic shelves
Refrigeration System	Hermetic, air conditioned, with heat exchanger and capillary input
Evaporator	Static evaporator with automatic defrosting
Standard Equipment	Electronic controlled digital thermometer/thermostat/defrost timer with alarm light, (adjustable low and high temperature alarm limits) and an option to external alarm (potential free relais contact),TTL -Mod Bus (RS 485) port for the option to connect to PC, readiness for additional probes
	Alternatives and accessories, see the price list
Note!	Refrigeration data are given according to ISO 8561 standard and volumes according to EN441standard
M1, VL	
Frame	White melamine coated panel
Door and drawer	White laminated door and drawers are lockable, reversible door
Feet	Steel base frame, 4 pcs of adjustable 20 mm knurled-head screws
Shelves	Plastic shelves dimensioned for medicines
Standard Equipment	M1: interior light with door switch, lockable drawer for drugs with different key series as for the door
	VL: Drawer with 3 or 6 drawers, central locking
	Alternatives and accessories, see the price list
Note!	Volumes are given according to EN441 standard

Dimension drawings M1 + MC 70, MC 70 + VL

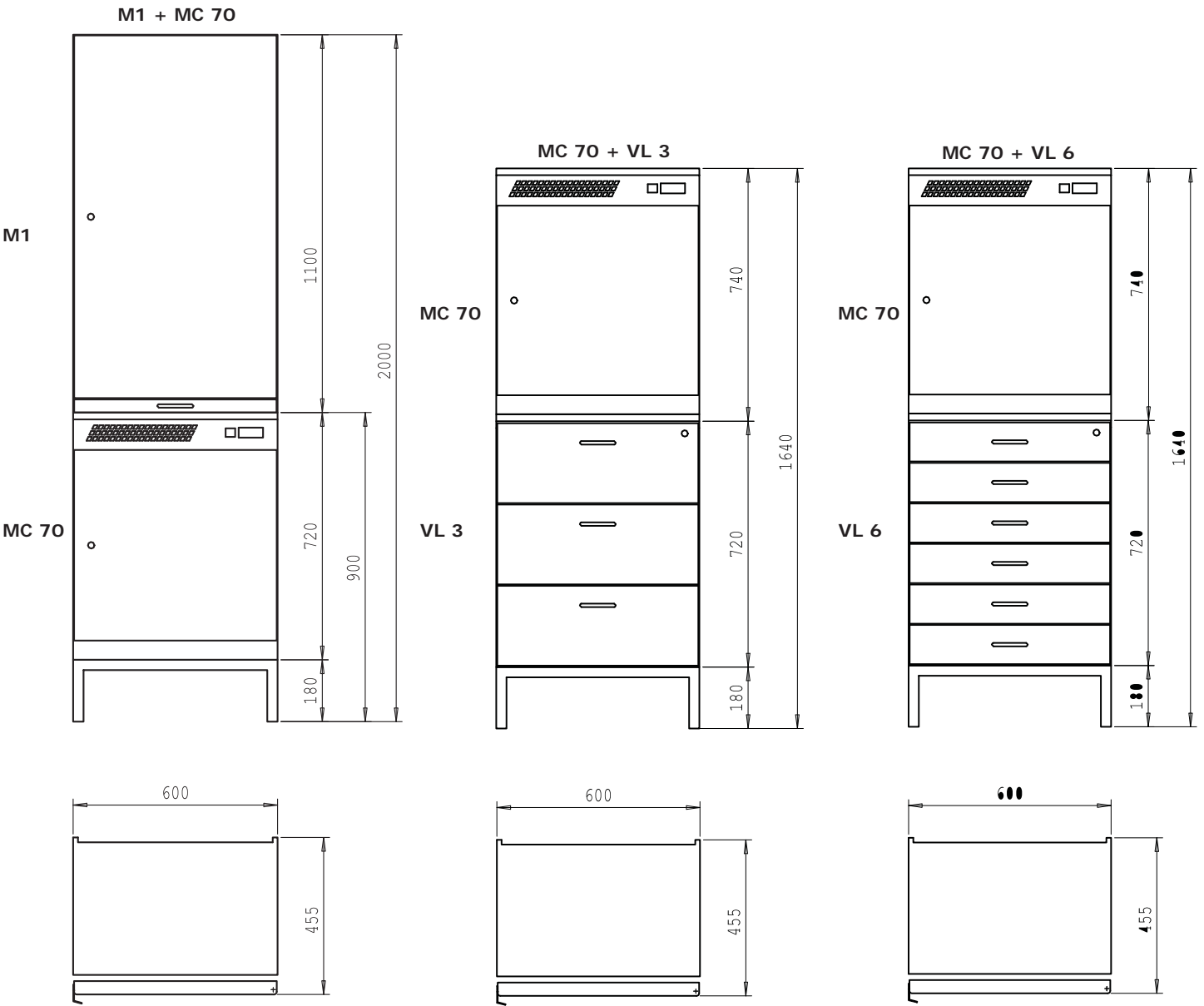

Technical data M3+MC180, MC180+M3, MC180+VL4, MC180+VL2

				M3+MC180	MC180+M3	MC180+VL4	MC180+VL2
Ext. dimension	width	(mm)		596	596	596	596
	depth	(mm)	(+handle)	480+25	480+25	480+25	480+25
	height	(mm)	(wall installation)	-	-	-	-
	height	(mm)	(free-standing)	2000	2000	2000	2000
Int. dimension	width	(mm)		560/495	495/560	495/560	495/560
	depth	(mm)		380/360	360/380	360/380	360/380
	height	(mm)		425/940	940/425	940/425	940/425
Volume net		(l)		85+130	130+85	130+70	130+70
Volume gross		(l)		90+170	170+90	170+90	170+90
Weight		(kg)		90	90	100	100
Shelves	width	(mm)		560/490	490/560		
	depth	(mm)		380/155	155/380		
Drawers	width	(mm)				-/525	-/525
	depth	(mm)				-/380	-/380
	height	(mm)				-/95(x3) + 70(x1)	-/180(x2)
	height	(mm)					
Door shelves	width	(mm)		-/470	470/-	470/-	470/-
	depth	(mm)		-/100	100/-	100/-	100/-
Amb. Temperature		(°C)		+5...+32	+5...+32	+5...+32	+5...+32
Operating temperature		(°C)		+2...+15	+2...+15	+2...+15	+2...+15
Connection power		(W)		190	190	190	190
Cooling effect		(W)		137	137	137	137
evaporator/condensor/ambient				-10°C/+55°C/+32°C	-10°C/+55°C/+32°C	-10°C/+55°C/+32°C	-10°C/+55°C/+32°C
Refrigerant				R 134A / 100g	R 134A / 100g	R 134A / 100g	R 134A / 100g
Fuse (slow)		(A)		10	10	10	10
Voltage		(V)		230/50 Hz	230/50 Hz	230/50 Hz	230/50 Hz
Defrost				3	3	3	3
1. Air							
2. Hotgas							
3. Electric							

Technical data M3+MC180, MC180+M3, MC180+VL4, MC180+VL2

MC180	
Exterior finish	Visible exterior surface: white polyester-coated sheet steel; back wall, top and bottom galvanised sheet steel
Interior finish	Vacuum formed polystyrene
Insulation (body)	40 mm foamed, CFC and HCFC free polyurethane
Door	Equipped with magnetic gasket and lock, reversible
Feet	MC180, MC150/150 and MC300 4 pcs adjustable 20 mm fingerscrews, MC70 with steel base frame
Inside	Plastic shelves
Refrigeration system	Hermetic, air conditioned, with heat exchanger and capillary
Evaporator	Static evaporator with automatic defrosting
Standard equipment	Electronic controlled digital thermometer/thermostat/defrost timer with alarm light, (adjustable low and high temperature alarm limits) and an option to external alarm (potential free relais contact),TTL -Mod Bus (RS 485) port for the option to connect to PC, readiness for additional probes
	Alternatives and accessories, see the price list
Note !	All data and volumes are given according to ISO 8561
M3, VL4, VL2	
Frame	White melamine coated panel
Door and drawer	White laminated door and drawers are lockable, reversible door
Feet	Steel base frame, 4 pcs of adjustable 20 mm knurled-head screws
Shelves	Plastic shelves dimensioned for medicines
Standard Equipment	M1: interior light with door switch, lockable drawer for drugs with different key series as for the door
	VL: Drawer with 2 or 4 drawers, central locking
	Alternatives and accessories, see the price list
Note!	Volumes are given according to EN441 standard

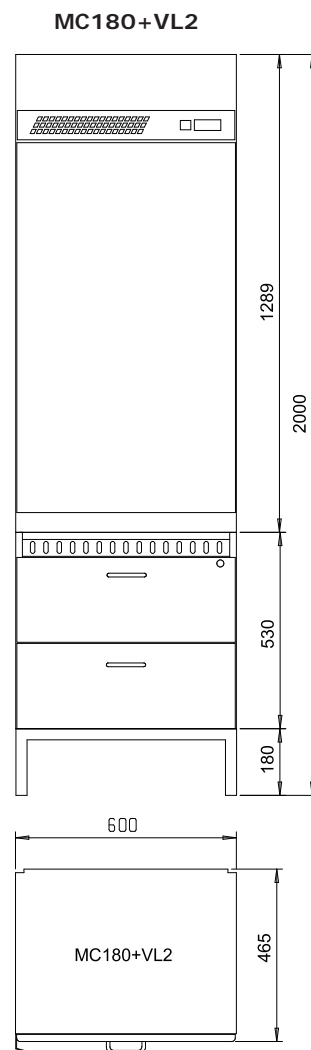
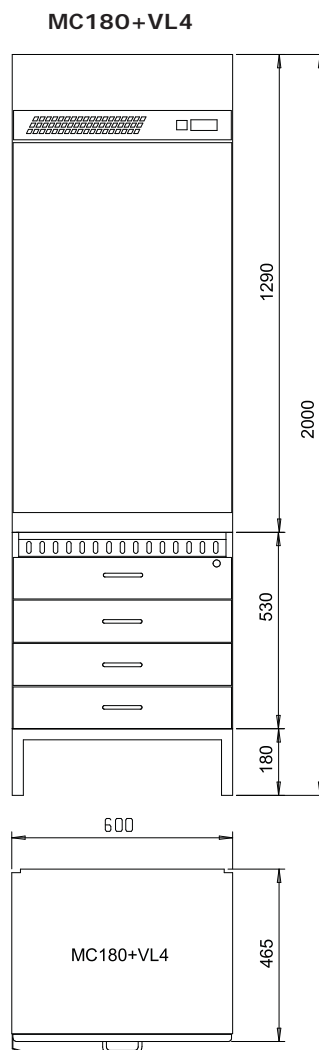
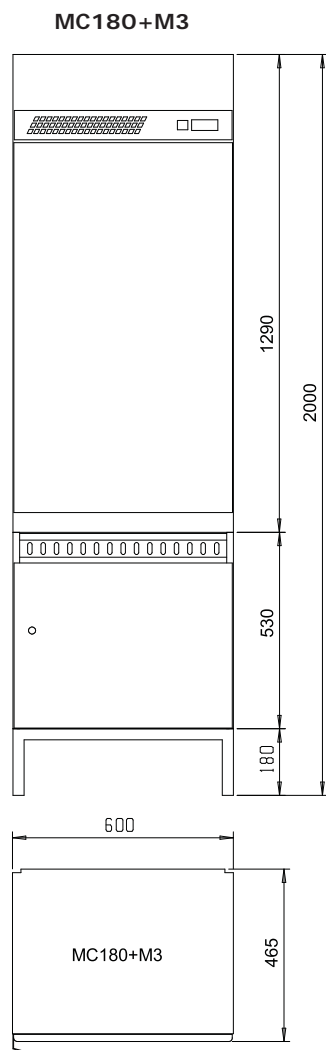
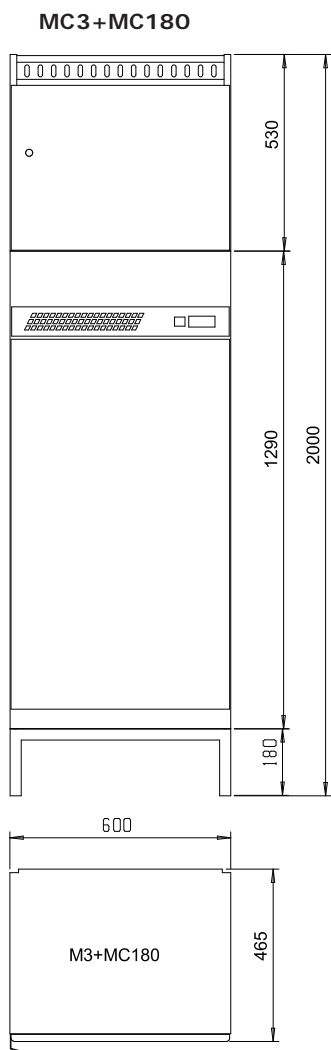

MR1292



PORKKA

Porkka Finland Oy is an internationally recognised designer and manufacturer of refrigeration equipment. Major clients include commercial kitchens, restaurants, fast food outlets, hotels, industrial canteens, hospitals, laboratories and retailers throughout Europe.

Our main markets outside of Finland include Scandinavia, United Kingdom, Germany, Switzerland, Holland, Belgium, Russia and the Baltic regions. 80% of the companies' turnover is derived from foreign transactions and exports. Ongoing and adaptive development by numerous foreign subsidiaries and representatives ensures our continued success.

Porkka's continued success is based on decades of experience, customer focused design and continuous product development. New innovative products are launched each year.

Porkka Finland Oy is part of the Huurre Group. Porkka and Huurre brands are well known for their quality and reliability.

Distributed and Supported in the UK by:



24 Norman Way Industrial Estate, Over, Cambridge, CB24 5WE
Tel: +44(0)1954 233 100 Fax: +44(0)1954 233 101
Email: sales@camlab.co.uk Web: www.camlab.co.uk

Contains fluorinated greenhouse gases covered by the Kyoto Protocol. Refrigerant and charge size can be found on the name plate. Hermetically sealed equipment.

R404A GWP=3800
R134a GWP=1300



All rights reserved
© Porkka Finland Oy