

Lab washers PG 8535 and PG 8536

PG85
Perfection
Guaranteed



Compact high-tech washer-disinfector with freely programmable controls

Washer-disinfector PG 8535

- Built-under/freestanding units
- Stainless-steel casing
- Width 90 cm
- H 820* (850), W 900, D 700 mm
- Freely programmable PROFITRONIC+ controls with 17 programmes and 30 vacant programme slots
- Network interface for process documentation
- 400 l/min circulation pump capacity
- PerfectSpeed Sensor spray arm monitoring
- 3-phase supply for short programme cycles
- 2 bellows-type dispenser pumps for liquid detergent and neutralising agent
- Drawer with 2 supply canisters, 5 l each
- Integrated hot-air drying unit
- Reprocessing per cycle:
e.g. 37 narrow-necked glasses or 96 pipettes



Compact high-tech washer-disinfector with freely programmable controls

Washer-disinfector PG 8536

- Freestanding unit
- Stainless-steel casing
- Width 90 cm
- H 1175, W 900, D 700 mm
- Freely programmable PROFITRONIC+ controls with 18 programmes and 30 vacant programme slots
- Network interface for process documentation
- High-performance units with water circulation capacity of 600 l/min
- PerfectSpeed Sensor spray arm monitoring
- 3-phase supply for short programme cycles
- 2 integrated, maintenance-free bellows-type dispenser pumps liquid detergent and neutralising agent, incl. PerfectFlow ultrasound volumetric dispensing
- Drawer with 4 supply canisters, 5 l each
- Integrated hot-air drying unit
- Reprocessing per cycle:
e.g. 66 narrow-necked glasses or 96 pipettes

Optional version with gaskets with improved oil and grease resistance for use in petrochemical, cosmetics and food-processing industry.

* Built-under unit

Technical data PG 8535 and PG 8536

Washer-disinfectors	PG 8535	PG 8536
Frontloading unit with bottom-hinged door, excl. baskets	•	•
Built-under/freestanding unit without lid	•	-
Freestanding unit with lid	-	•
Freshwater system, max. temperature 93°	•	•
Circulation pump [Qmax l/min]	400	600
Controls/programmes		
PROFITRONIC+, freely programmable	•	•
64 programme slots	•	•
Spray arm sensing	•	•
Magnetic strip for automatic mobile unit recognition	•	•
Conductivity metering	-	Optional
Network interface for process documentation	•	•
Serial printer interface for process documentation	•	•
Remote service enabled	•	•
Electric door lock	•	•
Peak-load negotiation	•	•
Water connections		
1 x cold water, flow pressure	50 - 1000 kPa	200 - 1000 kPa
1 x cold water for steam condenser, flow pressure	50 - 1000 kPa	200 - 1000 kPa
1 x hot water, flow pressure	50 - 1000 kPa	200 - 1000 kPa
1 x demineralised water, flow pressure	50 - 1000 kPa	50 - 1000 kPa
Feed pump for unpressurised demineralised water	Optional	Optional
4 inlet hoses ½" with ¾" threaded union, (l = approx. 1.7 m)	•	•
Drain pump DN 22, head height 100 cm	•	•
Steam condenser water drain (DN 22)	•	•
WaterProof System (WPS)	•	•
Electrical connection		
3 N AC 400 V 50 Hz, supply lead approx. 1.7 m, 5 x 2.5 mm ²	•	•
Heating [kW]	9.0	9.0
Circulation pump [kW]	0.7	1.2
Total rated load [kW]	9.7	10.2
Fuse rating [A]	3 x 16	3 x 16

• = Standard, - = Not available

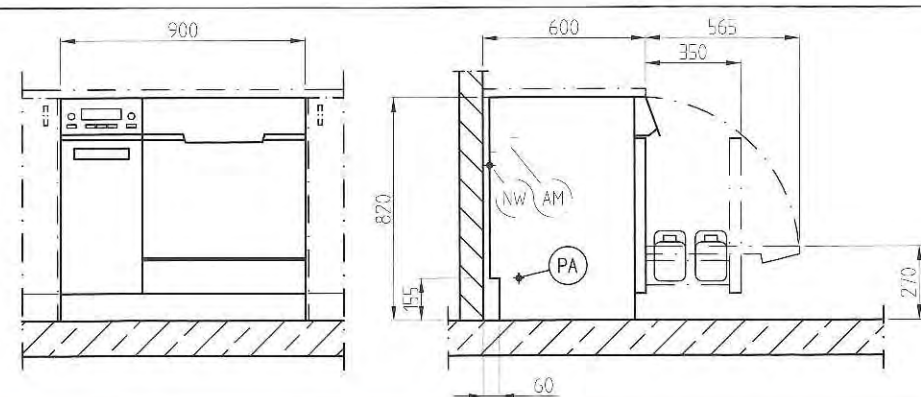

PG 8535

Washer-disinfectors	PG 8535	PG 8536
Dispenser systems		
1 dispenser pump for liquid acidic agents	• (peristaltic pump)	• (bellows-type pump)
1 dispenser pump for liquid detergent	• (peristaltic pump)	• (bellows-type pump)
1 connection for external DOS G10 or DOS G60 dispenser module	•	-
DOS S20 dispenser pump for neutralising agent and surfactant	-	Optional
DOS NA120 dispenser pump for disinfectant or liquid detergent	-	Optional
PerfectFlow ultrasound volumetric dispenser control	-	•
Drawer for 2 x 5 l supply canisters	•	-
Drawer for 4 x 5 l supply canisters	-	•
Applications involving oils and greases:		
Oil- and grease-resistant gasket	Optional	Optional
Water softener		
for cold and hot water to max 70°, Monobloc softener	•	-
for cold and hot water, max 70°, large-capacity water softener	-	•
Steam condenser		
Aerosol	•	•
Drying unit		
Fan motor [kW]	0.3	0.3
Heater bank [kW]:	2.3	2.3
Total rated load [kW]	2.6	2.6
Air throughput [m ³ /h]	60	60
Temperature selection in 1 ° increments [°C]	60-115	60-115
Time selection in 1-minute increments [min]	1-240 min	1-240 min
Pre-filter EU 4, filter rating > 95%, filter life 100 h	•	•
Particulate filter/HEPA filter H 13,		
Filtration rate >99.992% (DIN EN 1822), life cycle 500 h	•	•
Dimensions, weight		
External dimensions H / W / D [mm]	820/900/700	1175/900/700
Cabinet dimensions H / W / D [mm]:	500/535 O*=473, U*=516	500/535 O*=473, U*=516
Weight [kg]	114	177
Outer casing		
Stainless steel (AE)	Stainless steel	Stainless steel
Compliance with standards		
DIN EN ISO 15883-1/2, EN 61010-2-40, EN 61326	•	•
Test certificates		
VDE, VDE-EMC, MPG CE0366, IP20	•	•

*O=Upper basket, U = Lower basket,

• = Standard, - = Not available

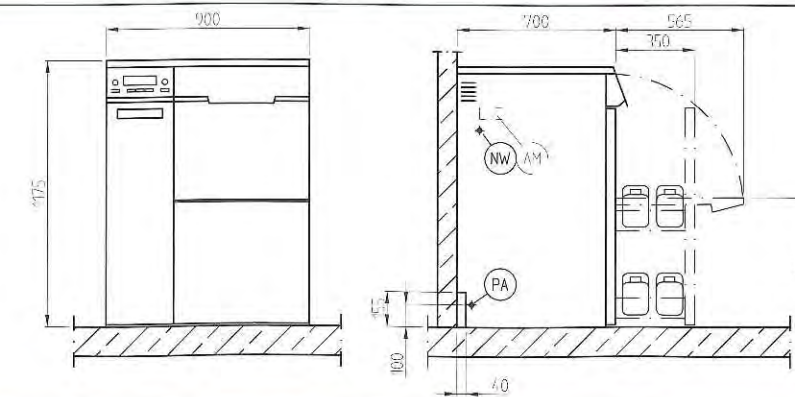

PG 8536

The technical data contained in this brochure applies mainly to continental Europe.
www.miele-professional.com provides detailed information on national versions and voltages.