



## 3M™ Versaflo™ TR-300 Powered Air Respirator

To maintain protection levels, optimise the effective lifetime of the system and avoid the additional cost of replacement, it is extremely important to carry out regular checks and maintenance.

### ► Before Use

- Use indicator button to confirm battery charge.
- Ensure correct filter is fitted.
- If spark arrestor and/or pre-filter are used ensure they are clean.
- Use air-flow indicator to confirm correct flow rate. If ball is below the line at first it may rise further – allow up to 90 seconds for the flow to stabilise. Change filter if ball does not stabilise above the line.
- Visually inspect for damage.

### ► Monthly

- Carry out all the 'Before Use' inspections and create record of this monthly check.

### ► After Use

- Clean with cloth dampened with a mild solution of water and liquid household soap.
- Disinfect with 3M 105 Wipes.
- Store in a dry, clean area / locker away from direct sunlight, high temperatures and solvents.

### ► Ordering Consumables, Repair Parts and Accessories

To request a quote or place an order for these items, please contact your 3M Approved Distributor.

### ► Further Information and Advice

If you require additional guidance on the Care and Maintenance of your 3M Powered and Supplied Air Equipment, please contact the Helpline or your local 3M representative.

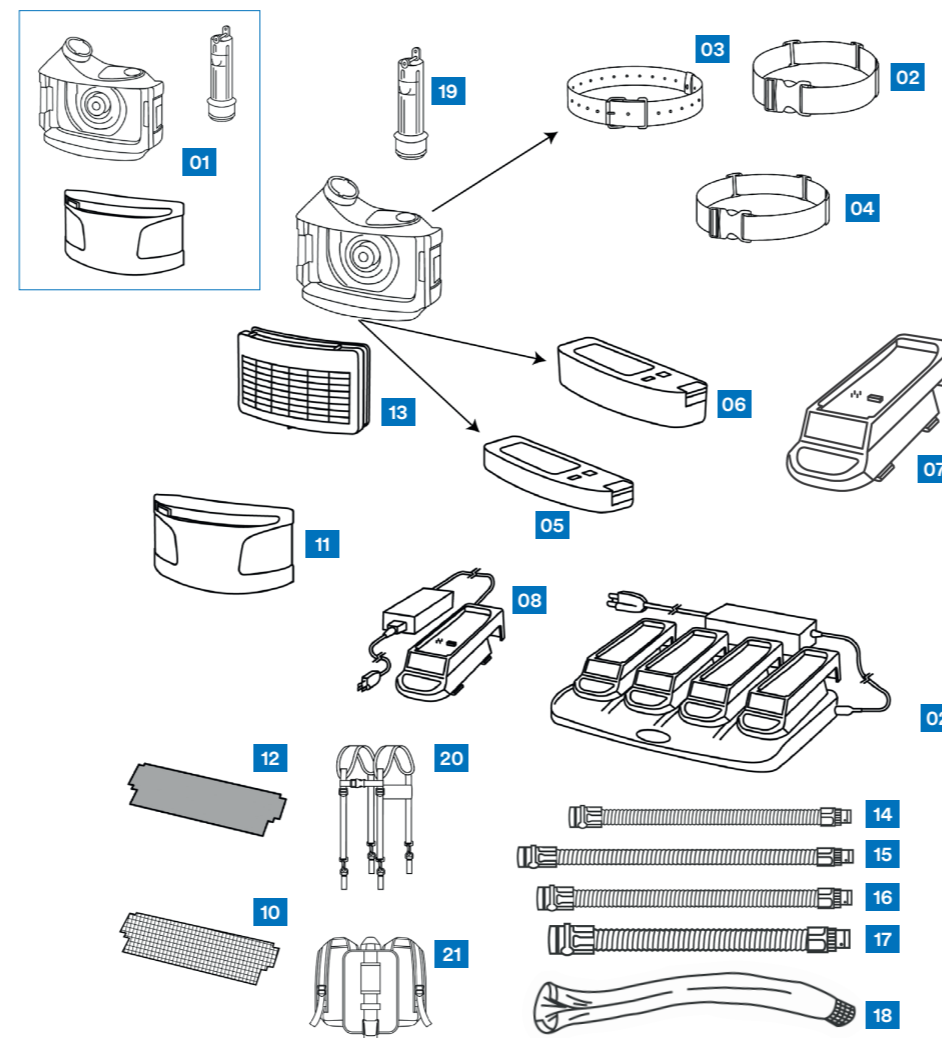

Description	Part N°
01 Versaflo TR-302E Powered Air Turbo Unit (complete with Filter Cover and Air Flow Indicator)	TR-302E
02 Standard Belt	TR-325
03 Leather Belt	TR-326
04 Easy-Clean Belt	TR-327
05 Economy Battery Pack	TR-330
06 High Capacity Battery Pack	TR-332
07 Battery Charging Cradle	TR-340
08 Single Station Charger Kit	TR-341UK
09 4 Station Battery Charging Kit	TR-344UK
10 Spark Arrestor	TR-362
11 Replacement Filter Cover	TR-370
12 Pre-Filter	TR-3600
13 Particulate Filter	TR-3712E
13 P/Nuisance Level Organic Vapour Filter	TR-3802E
13 P/HF/Nuisance Level Acid Gas Filter	TR-3822E
14 Short Lightweight Breathing Tube	BT-20S
15 Long Lightweight Breathing Tube	BT-20L
16 Length Adjusting Breathing Tube	BT-30
17 Heavy Duty Rubber Breathing Tube	BT-40
18 Breathing tube cover - Flame and Heat Resistant, High Durability	BT-926
19 Airflow Indicator	TR-970
20 Braces	TR-329
21 Backpack	BPK-01

**Replace all damaged parts immediately to ensure correct levels of protection.**

3M Personal Safety Division  
3M United Kingdom plc  
3M Centre, Cain Road  
Bracknell, Berkshire RG12 8HT  
United Kingdom  
Tel: 0870 60 800 60  
www.3M.co.uk/safety

3M Ireland Limited  
The Iveagh Building  
The Park  
Carrickmines  
Dublin 18  
Tel: 1 800 320 500

Please recycle. Printed in UK.  
3M and Versaflo are trademarks of the 3M company.  
© 3M 2015. All rights reserved.  
J308790



CHTR300CMP  
To download this poster please visit:  
[www.3M.co.uk/maintenancepack](http://www.3M.co.uk/maintenancepack) or scan the QR code.

For more information on all our products, call 3M Personal Safety Division on 0870 60 800 60 (UK) and 1800 320 500 (Ireland) or visit [www.3M.co.uk/safety](http://www.3M.co.uk/safety)

@3M\_UK\_Safety

**3M Health & Safety Helpline**  
Monday - Friday 9 to 5  
**0870 60 800 60 - UK**  
**1 800 320 500 - IRELAND**